

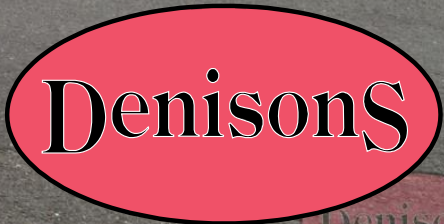

67 Clarendon Road



67 Clarendon Road

Christchurch, BH23 2AB

£479,950

This stunning detached 3/4 bedroom family home is situated in an enviable location, offering the perfect blend of privacy and convenience. The property is ideally situated within walking distance of the train station, school, and Christchurch Town Centre, making it a fantastic choice for those seeking a vibrant and accessible location. The spacious interior of the house is sure to impress, with an open-plan kitchen, living, and dining area providing the perfect space for family living and entertaining. The property boasts two generously sized double bedrooms, one small double, and the option for a downstairs fourth double bedroom that could also be used as a second reception room. This versatile space ensures that the property can adapt to the changing needs of any family. Outside, the low-maintenance garden provides a tranquil oasis, perfect for relaxing and entertaining guests. With parking for four or more vehicles, this property is the perfect choice for those seeking a spacious and convenient family home.



Lounge 12' 10" x 12' 1" (3.91m x 3.68m)

Dining Room 9' 11" x 12' 5" (3.02m x 3.78m)

Kitchen/Utility Room 8' 2" x 18' 1" (2.49m x 5.51m)

Bedroom/2nd reception room 9' 11" x 13' 0" (3.02m x 3.96m)

Master bedroom 9' 11" x 13' 0" (3.02m x 3.96m)

Bedroom 1 9' 11" x 12' 6" (3.02m x 3.81m)

Bedroom 3 8' 1" x 8' 11" (2.46m x 2.72m)



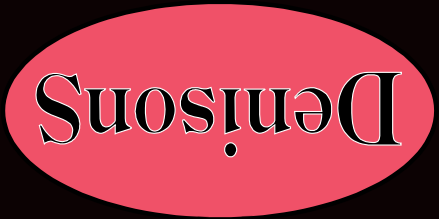

Denisons for themselves and for the Vendors or lessors of this property, whose Agents they are, give notice that these particulars are produced in good faith, are set out as a general guide only and do not constitute any part of a Contract. No person in the employment of Denisons has any authority to make or give any representation or warranty whatever in relation to this property.

christchurch@denisons.com

01202 484748

12 Castle Street, Christchurch BH23 1DT

Christchurch

Mayfair

Cashel House, London, W1U 3JT

0870 112 7099

mayfair@denisons.com

www.denisons.com



Total Area: 109.1 m² ... 1174 ft²

All measurements are approximate and for display purposes only.



Ground Floor

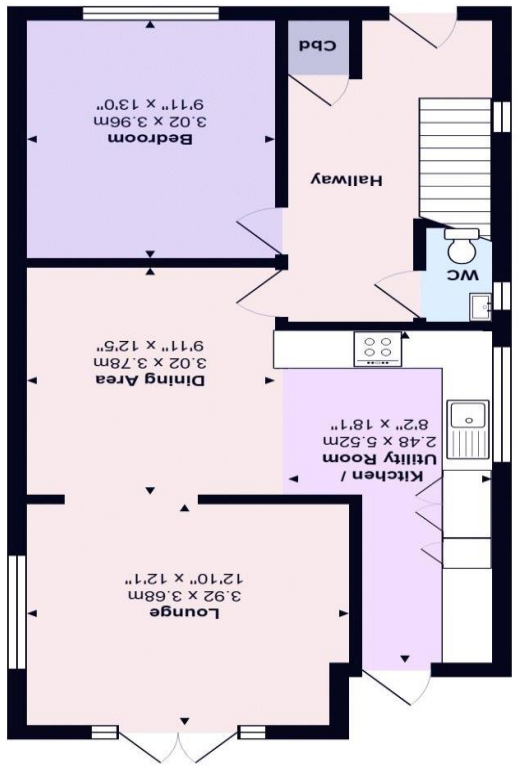

First Floor

